

# EUROJAMB

Flush shadowline door jamb system

PATENT PENDING



Euro Jamb - SL10

ALT-SK95SL - Skirting

 **ALTRO**

## Architectural Systems

Altro Building Systems manufactures and distributes innovative building solutions which bring a new level of control over what has previously been a difficult detail to build and maintain.

Altro strives to offer a range of Architectural specialty products that are highly sought after in the Building industry to achieve the desired level of finish and detail that is necessary in high profile projects.

Altro's comprehensive system which includes custom design and manufacture, along with short lead times, will help ensure your projects run smoothly so that you achieve consistent results.

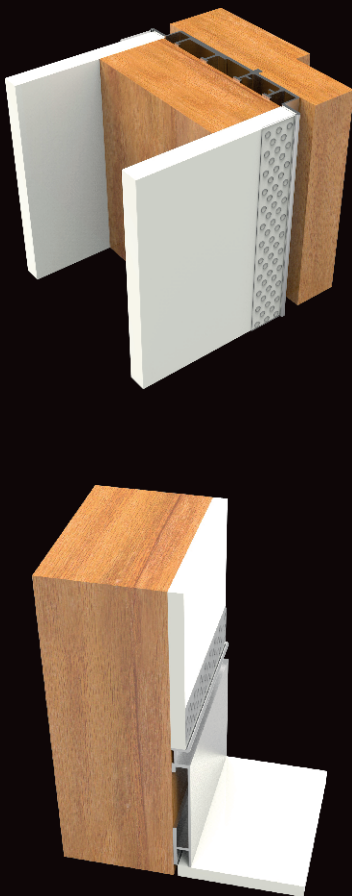

Detailing a shadowline profile around doorways, windows and skirting boards is the finish preferred by architects, although this can be frustrating for the building contractor to actually make it work and provide a defect free detail on site. The main issue the fit out contractor faces is the difficulty to achieve a straight line between metal shadowline bead and timber jamb. The end result is often disappointing with an uneven shadowline effect.

This dilemma has now been solved with the Eurojamb architectural door jamb system. Eurojamb is a single rebate design incorporating a 10mm shadowline detail within the profile. The Eurojamb system is simple to install due to a head/stile connector and location nib and is suited to wall thicknesses from 102mm to 160mm. Custom sizes greater than 160mm are available. Eurojamb can be specified with the confidence and assurance of a perfectly straight shadowline.



Eurojamb is also available with “Pier” concealed hinges which are adjustable in 3 dimensions. Altro also offers the service of in-house hinge mortising to jamb and door with precision CNC router machinery giving the builder absolute peace of mind knowing that the difficult part has been done and minimises on site work and human error.

The Pier concealed hinge system is completely invisible when the door is closed and takes centre stage when the door is open. Pier is the most comprehensive concealed hinge system for premium flush doors. Milling frames and templates are available for the Pier hinge system simplifying installation further.



The Eurojamb frame system is integrated in the wall and offers new design possibilities. The claim to this system was to integrate the 10mm shadowline into the wall design and create a clean, contemporary interior concept.

Eurojamb is ingenious and at the same time simple. Different rebate versions are available and can be even used as a pivot door.



## Installation Details

### Step 1

Insure that the stud opening is square and level and measures:

- Door width +90mm (100mm if using pier concealed hinges)
- Door height +45mm at header +25mm at floor level (Depending on floor clearance)

Important: The manufacturer strongly recommends a timber stud or a 0.75 BMT metal stud on both sides of the opening.

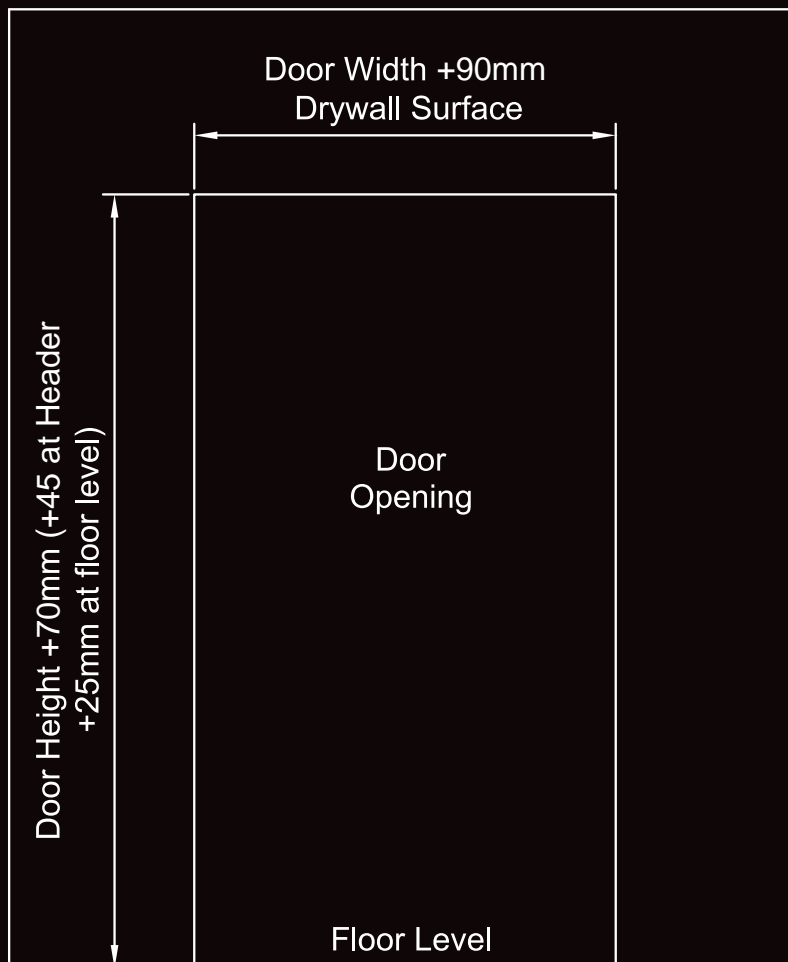

ELEVATION

## Step 2

Fasten hinge side first, making sure jamb is level and as tight against stud opening as possible. Then screw at 200mm (8") centres up stile, screwing back through plasterboard into stud work. Double screw all ends as *Detail D*. and beside hinge position – both above and below hinge if using pier hinges as *Detail E*.

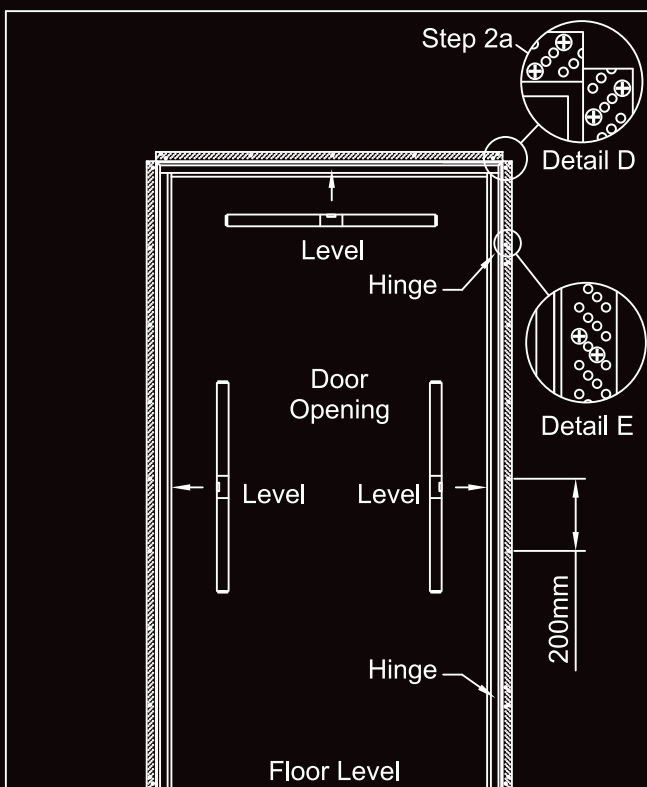
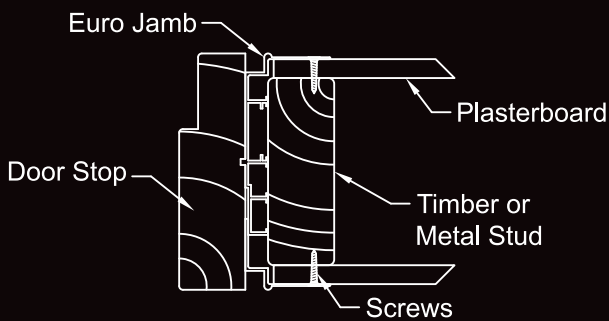

ELEVATION

## Step 2A

### HEAD INSTALLATION INSTRUCTION



Insert Head Joiner into Jamb. This step can be done on the ground and placed into the opening in one piece.

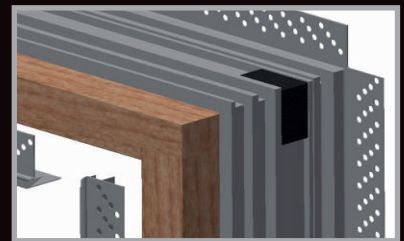

Insert shadowline reveals from other side of doorway.



Completed door jamb assembly ready to be screw fixed into timber or steel stud.

## Step 3

Fasten the final vertical section (strike jamb) below the head section. Ensure that the spacing between the two vertical sections are spaced evenly at the required distance.

ie: 820mm door, spacing is 825mm  
720mm door, spacing is 725mm

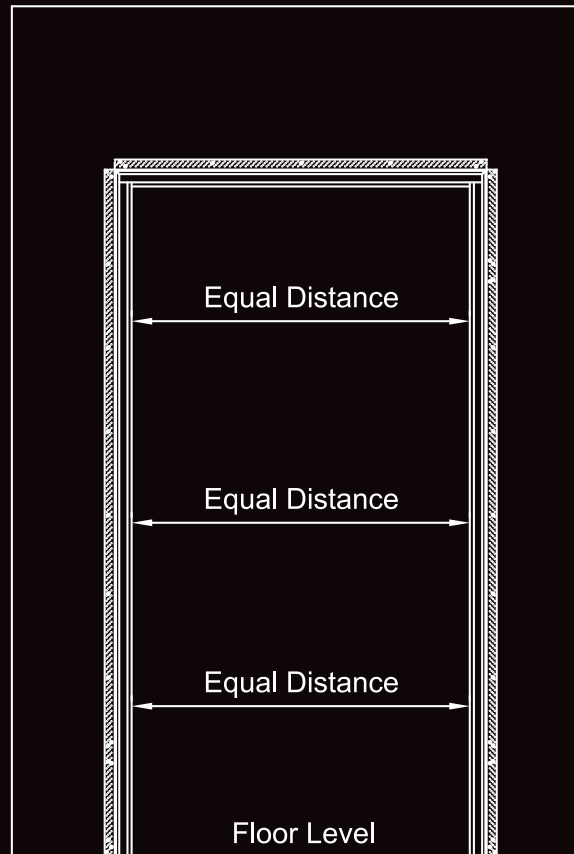
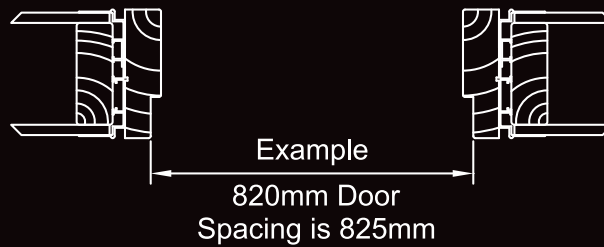

ELEVATION



## Step 4

Ensure the perforated side strips sit flat against the plasterboard to enable the jamb sections to be easily set into the surface. All the corners must be taped and plastered/joined in as Detail F. Finish the jamb with approved plaster/jointing compound. Hang the door into position leaving about 3mm (1/8") clearance from the top and the hinged side using the Eurojamb Standard or Concealed Hinges. Mount the strike where required into position.

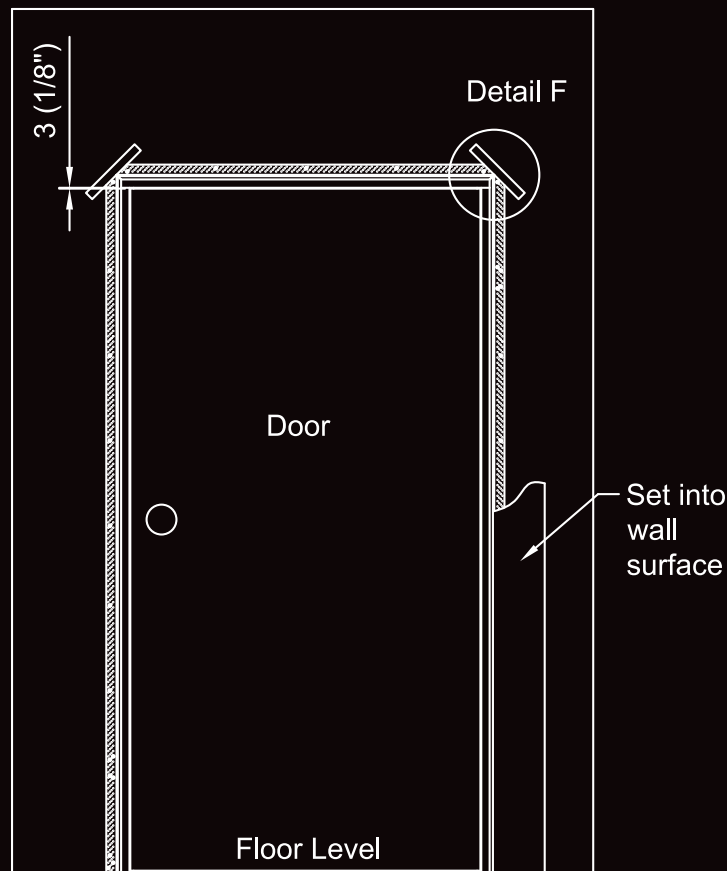
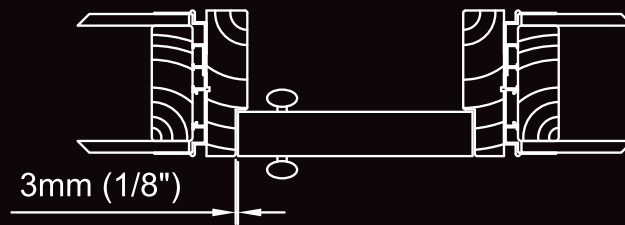

ELEVATION

## Installation Detail

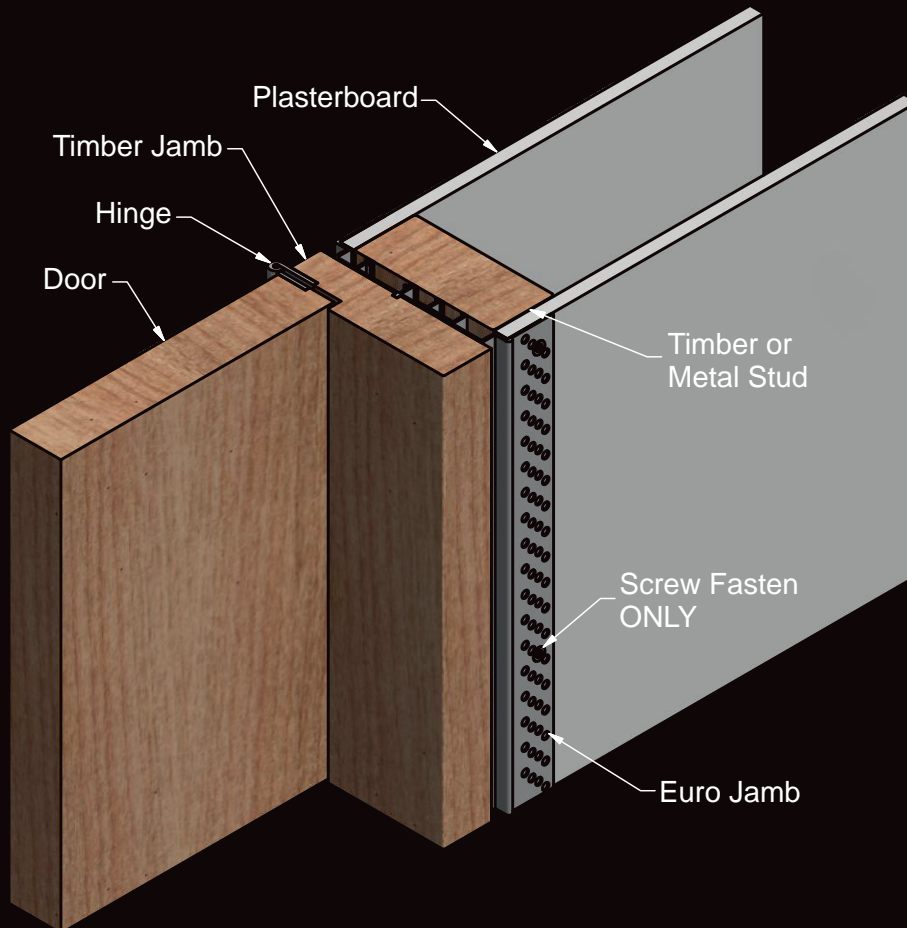

Butt hinges are to be rebated into timber jamb and door leaf. Rebating of butt hinges and concealed hinges can be done with Altro's CNC routing machinery if required.

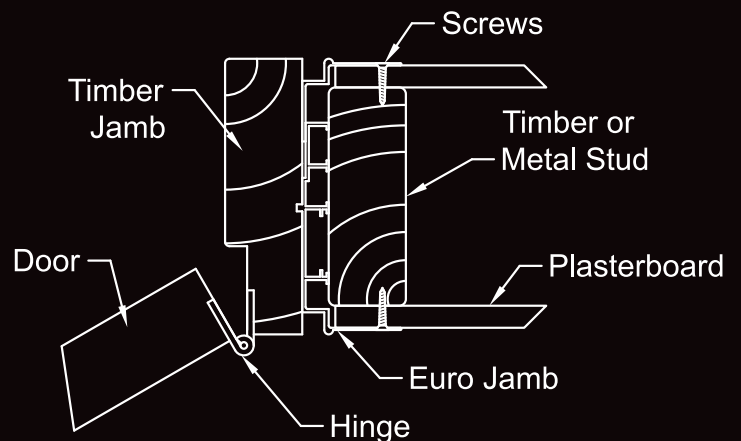

## Striker Plate

Rebate striker plate into timber jamb surface at required height.

Rebating of striker plates can be done with Altro's CNC routing machinery if required

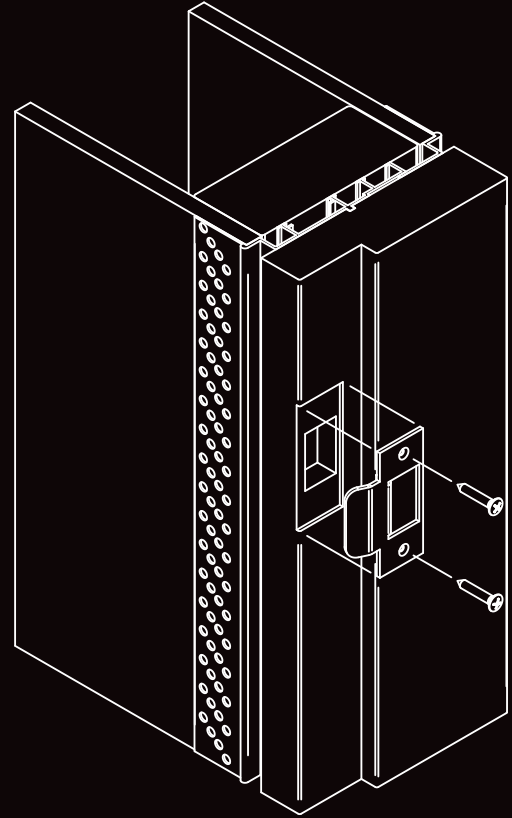

## Hinges Available

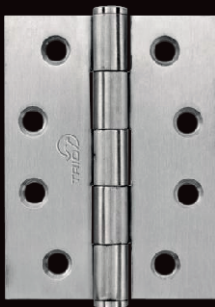

100 x 75 x 2.5mm "Pier" butt hinge  
in 304 grade stainless steel.

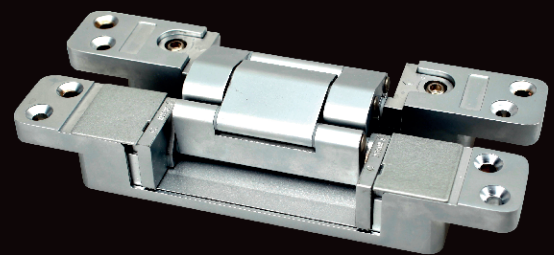

"Pier 3D concealed hinge adjustable  
in 3 dimensions.

Full specifications are available for the  
Pier concealed hinges.

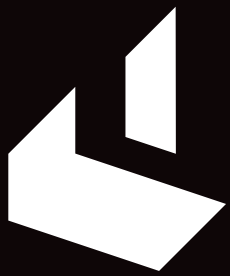

# EUROJAMB

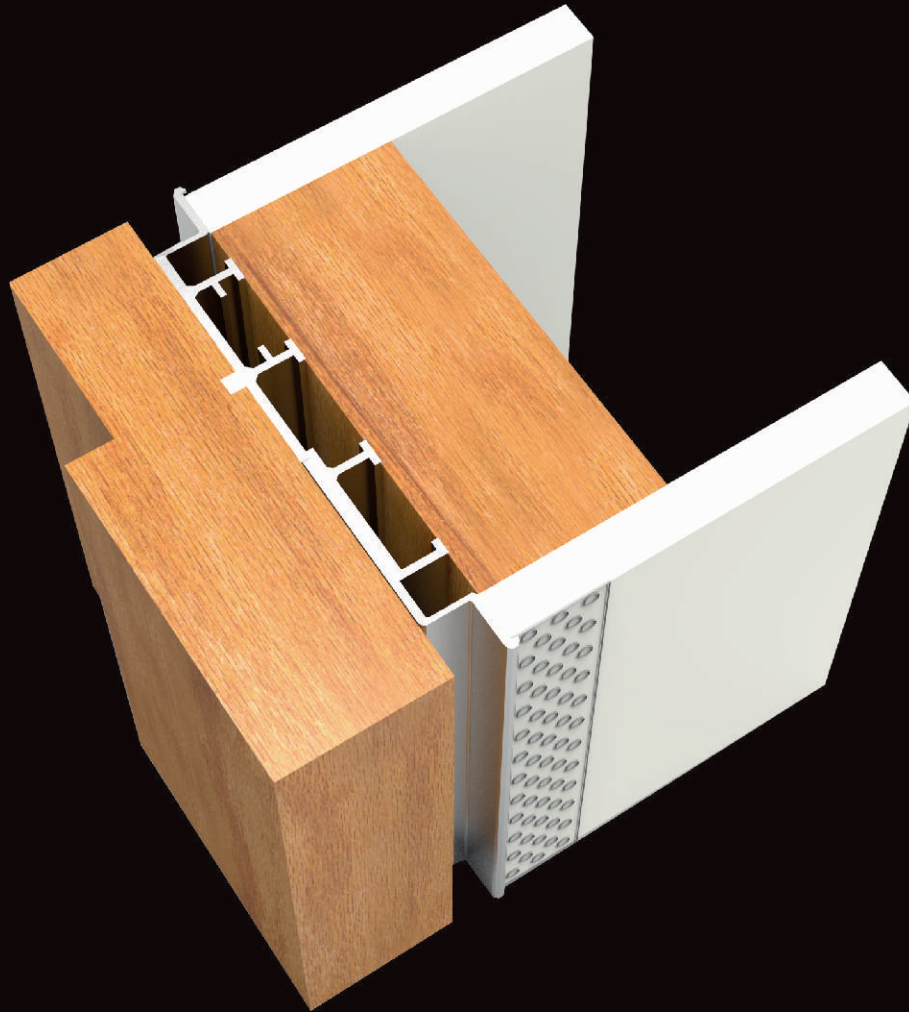

**Altro Building Systems**

PO Box 6192  
BAULKHAM HILLS BC NSW 2153

Tel: 1300 367 480  
Fax: 1300 766 197  
sales@altro.net.au | www.altro.net.au

