

ALTRO™ VACUUM CORNER



Our Mission

Altro Building Systems manufactures and distributes innovative building solutions which bring a new level of control over what has previously been a difficult detail to build and maintain.

Altro strives to offer a range of Architectural specialty products that are highly sought after in the Building industry to achieve the desired level of finish and detail that is necessary in high profile projects.

Altro's comprehensive system which includes custom design and manufacture, along with short lead times, will help ensure your projects run smoothly so that you achieve consistent results.

Our goal is to offer a complete range of optimised door capacities and of course, the ability to incorporate almost any detail and finish.





Euro Cav Ultima Cavity Sliding Door System

Features:

- Incorporates a precision, robust ball bearing carriage system that is fully concealed providing minimal detail.
- Focuses on elegant clean sharp lines which guarantee the ultimate choice for contemporary fitout.
- Environmentally friendly due to the high percentage of aluminium recycled in the building industry.
- High load bearing capacity making it ideal for large doors.
- Eliminates the need for architraves.
- Choice of square set, architrave or shadow line finish.
- Head track available in white powder coat or anodise finish.
- Available for 76mm, 90mm and 92mm stud thicknesses.
- Aluminium doors can be supplied as a fully manufactured product.
- Option of glass clamp carriage system for frameless glass doors.
- Swiss Soft Close Mechanism is optional, providing a much more gentle process of door closing & opening.

Advantages:

- Space saving design.
- Quick to install.
- Short lead times.
- No pelmets.
- Option of timber, aluminium or frameless glass doors.
- Custom made to suit your needs.
- Unique concealed carriage system.

The Euro Cav Ultima flush cavity sliding system available from Altro Building Systems has been designed to allow the underside of the track to finish flush with the ceiling for full height detail with minimal gap between door and ceiling.

The Euro Cav Ultima uses a concealed carrier system which is hidden in the top of the door and is still accessible at any time to remove door. This unique feature provides the absolute minimum of detail giving the ability to completely conceal the door and give the impression that the door does not exist when open and complete privacy when closed adding a contemporary and architectural dimension to any project. The Euro Cav Ultima Cavity Sliding Door system is also available in square set, architrave or shadow line finishes.

The top track system and running gear is robust and has been designed to take door weights of up to 150kg, 3000mm high and 2200mm wide thus making it the ideal solution for closing off large areas without taking up valuable space.

A soft close mechanism may be used with the Euro Cav Ultima. This innovative mechanism prevents doors from being slammed, providing a much more gentle manner to address the process of door closing.

The operation of the Altro Swiss Soft Close Mechanism is likened to the way a high-end supercar closes its doors. No matter how hard the door is slammed, the door panel will always slow down and gently stop on either open or closed door position.

Due to innovation, durability and ease of installation, the Euro Cav Ultima Cavity Sliding Door System is the architect's preference when detailing sliding door solutions for prestige projects.

The Euro Cav Ultima is ideal for Applications where minimising the gap between the door and track is a must. A retention device can also be installed inside the track that will stop and retain the door in position. The top track and split jambs have been extruded from a high tensile alloy to maximise strength and rigidity and are available in natural anodise or white powder coat finish. The Euro Cav Ultima brings a new level of control over what has previously been a difficult detail to build and maintain.



Altro Building Systems also has a range of Vetro Aluminium doors that can be used together with the Euro Cav Ultima Cavity Sliding System. The Vetro Aluminium doors are a space saving solution in modern day apartments and fully make use of the direct natural ambient light flooding in from the apartment windows.

The Vetro consists of either 100 x 37mm or 70 x 37mm aluminium frame that can be powder coated or anodised and are glazed and assembled in house eliminating extra trades on site. Vetro Doors are supplied as a complete system with recessed carriages, concealed T-guide system in base of door and channel for fixed screen beside door if required. Glazing options are almost infinite with choices ranging acid etch, translucent or even coloured glass.



Euro Cav Ultima - Square Set

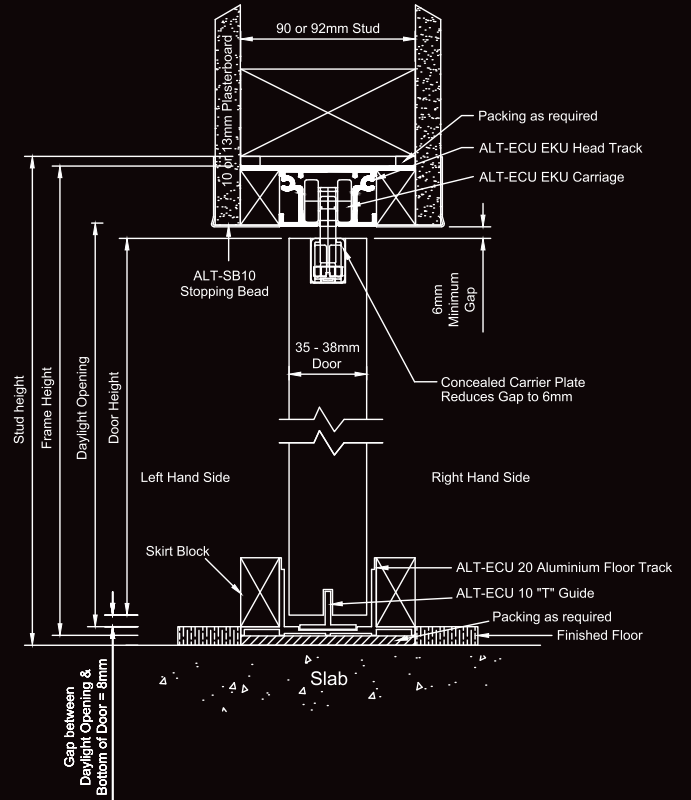
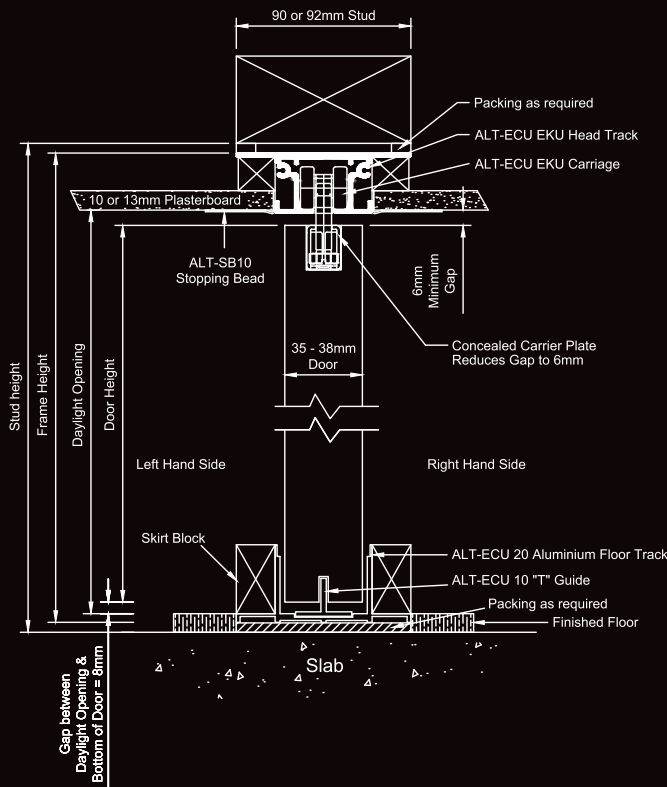

- FORMULAS**
- A) STUD OPENING WIDTH = DOOR WIDTH x 2 + 20mm
 - B) OVERALL OPENING HEIGHT = DOOR + 74mm
 - C) DAYLIGHT OPENING HEIGHT = DOOR + 15mm
 - D) CLEAR OPENING WIDTH = DOOR WIDTH - 20mm
 - E) CAVITY DEPTH = DOOR WIDTH + 13mm

OPTIONAL FLUSH CLOSING JAMB

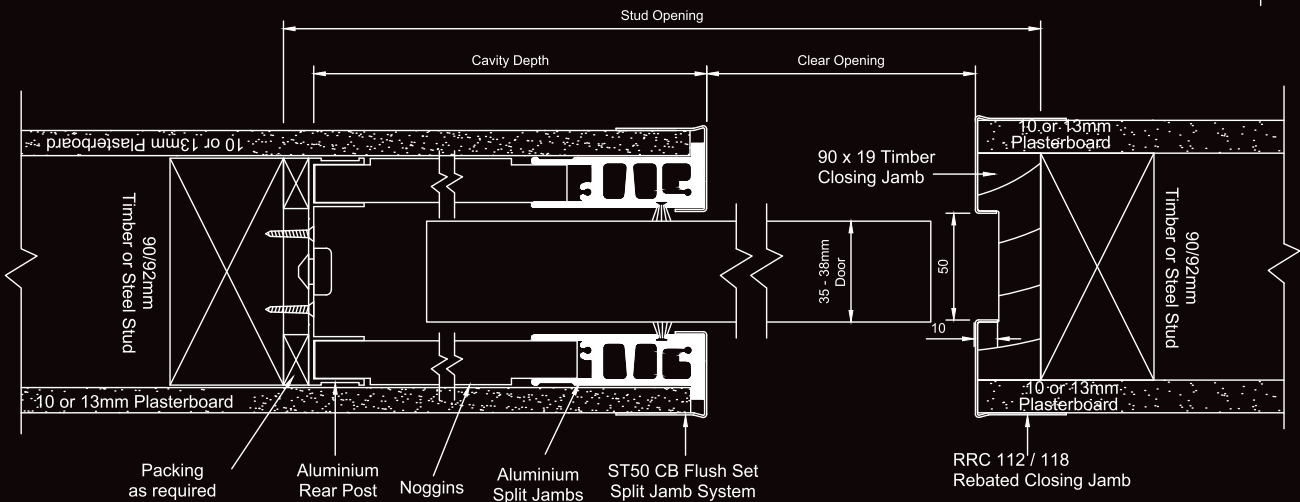
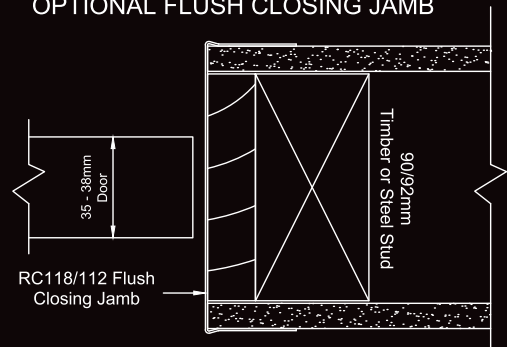

Euro Cav Ultima - 10mm Shadowline

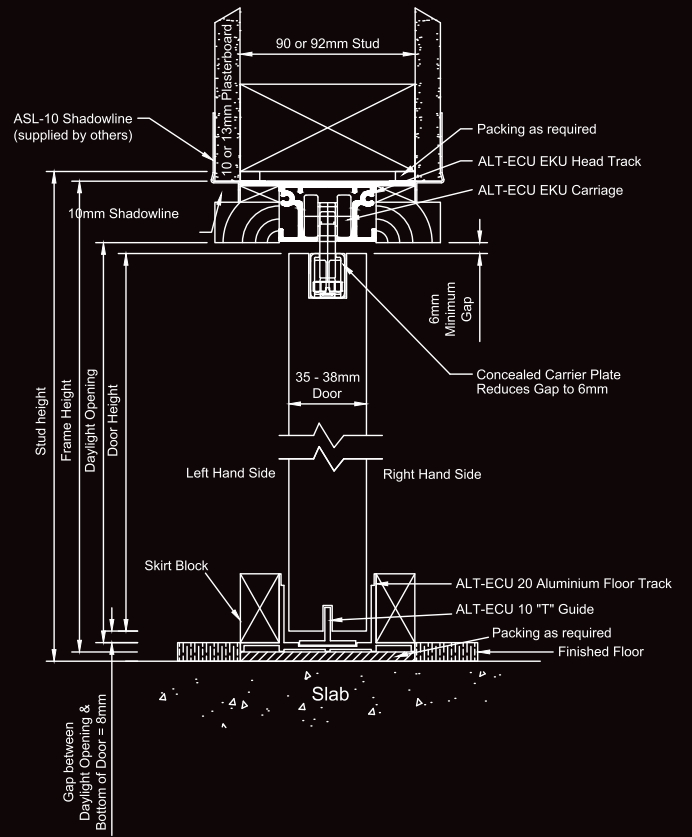
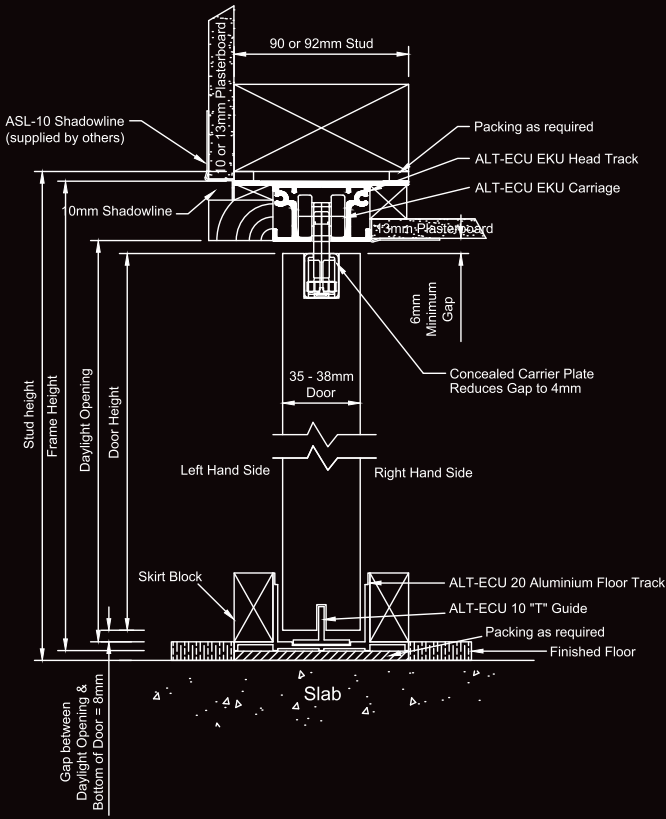

- FORMULAS**
- A) STUD OPENING WIDTH = DOOR WIDTH x 2 + 20mm
 - B) OVERALL OPENING HEIGHT = DOOR + 74mm
 - C) DAYLIGHT OPENING HEIGHT = DOOR + 15mm
 - D) CLEAR OPENING WIDTH = DOOR WIDTH - 20mm
 - E) CAVITY DEPTH = DOOR WIDTH + 13mm

OPTIONAL REBATE CLOSING JAMB

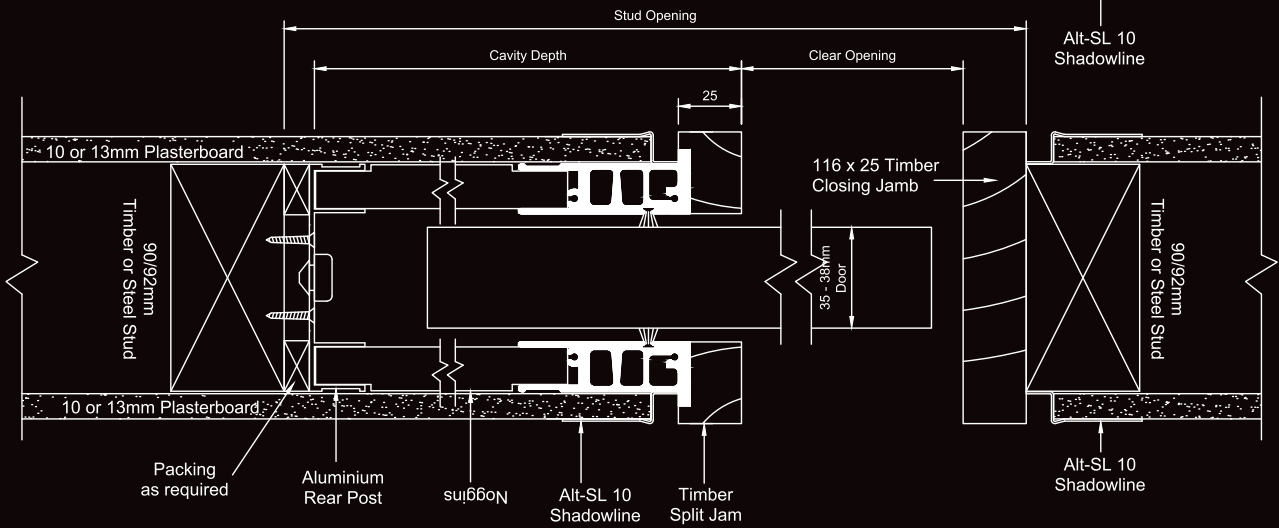
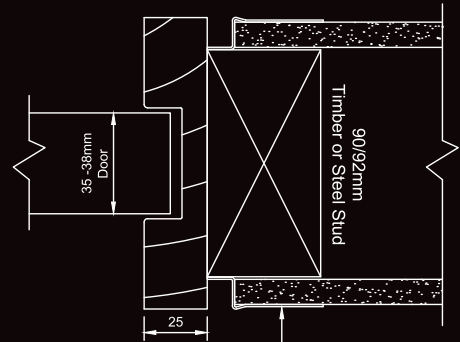

Euro Cav Ultima - Architrave

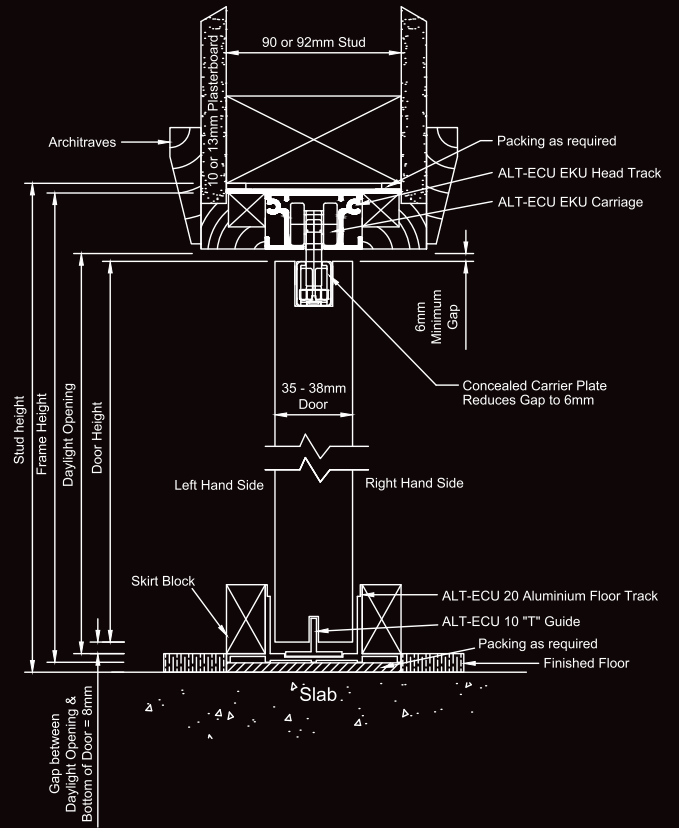
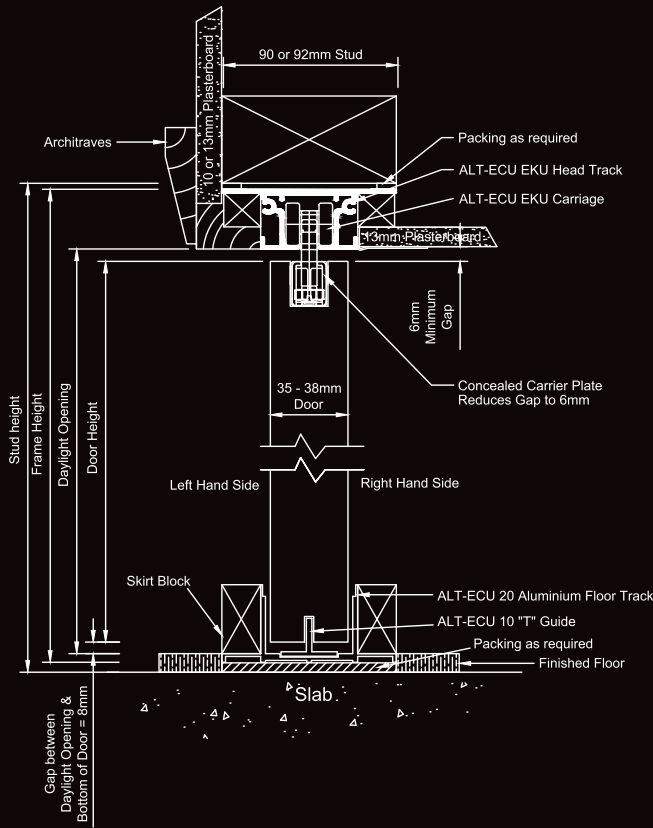

FORMULAS

- A) STUD OPENING WIDTH = DOOR WIDTH x 2 + 20mm
- B) OVERALL OPENING HEIGHT = DOOR + 74mm
- C) DAYLIGHT OPENING HEIGHT = DOOR + 15mm
- D) CLEAR OPENING WIDTH = DOOR WIDTH - 20mm
- E) CAVITY DEPTH = DOOR WIDTH + 13mm

OPTIONAL REBATE CLOSING JAMB

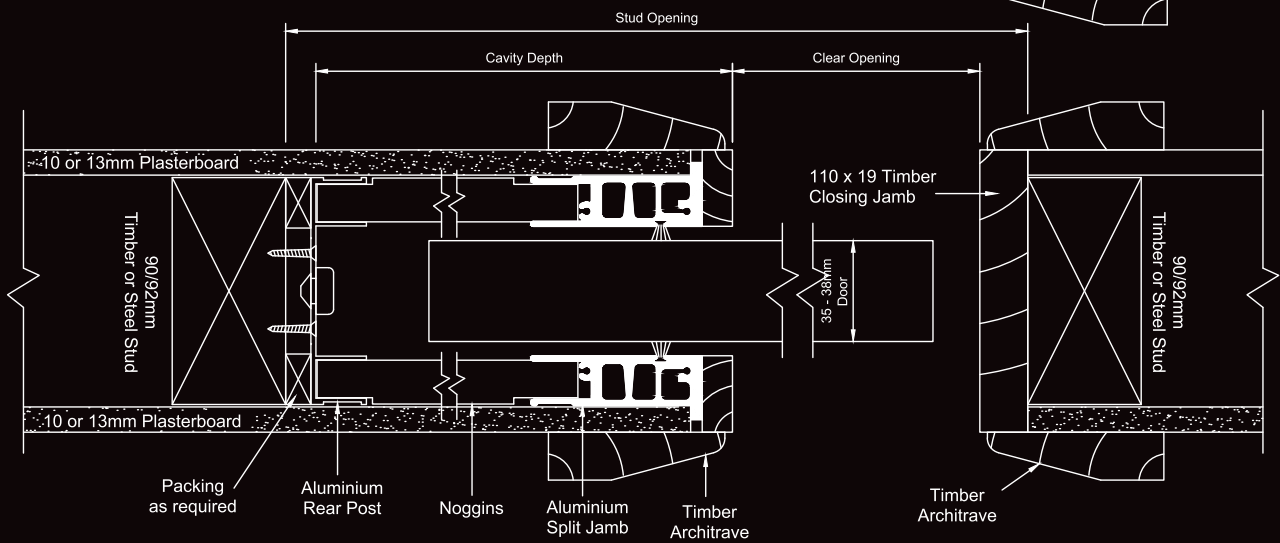
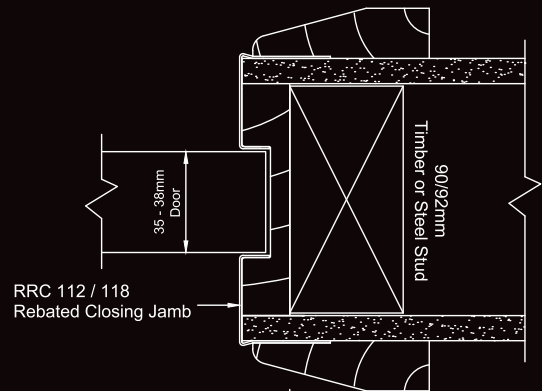

Euro Cav Ultima - Glass Door

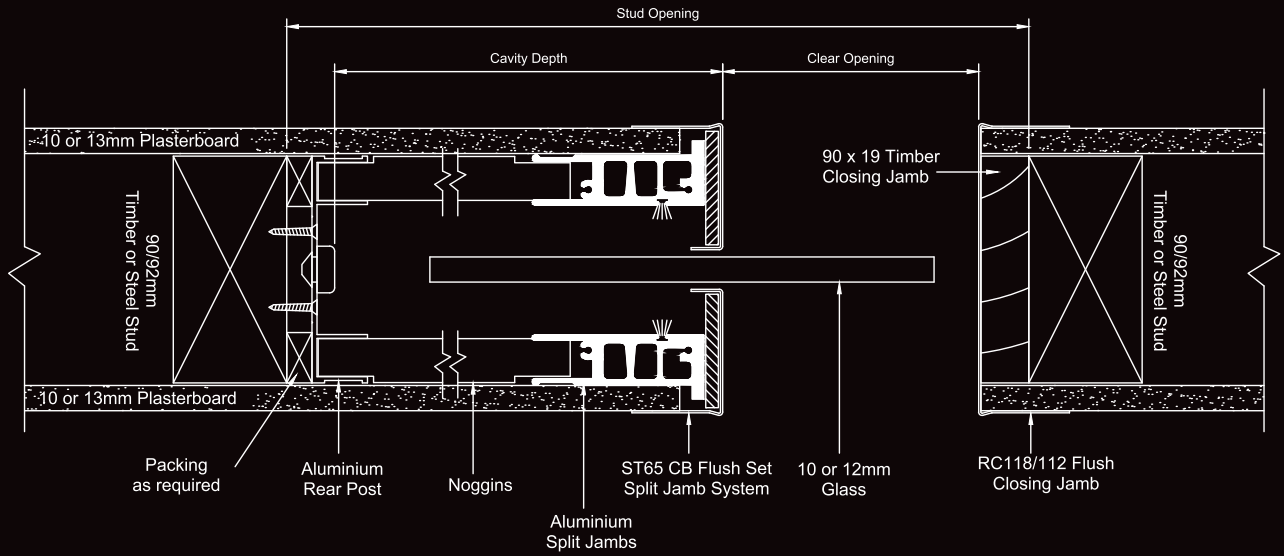
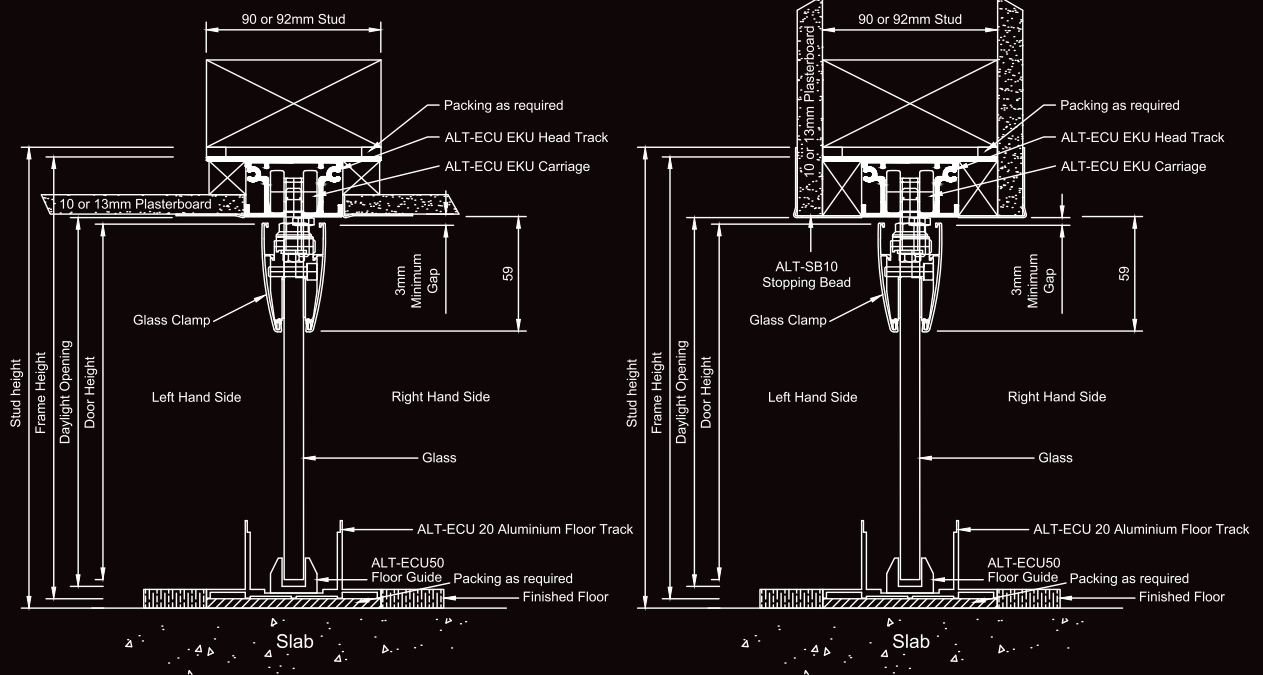

Euro Cav Ultima - Overtaking Doors

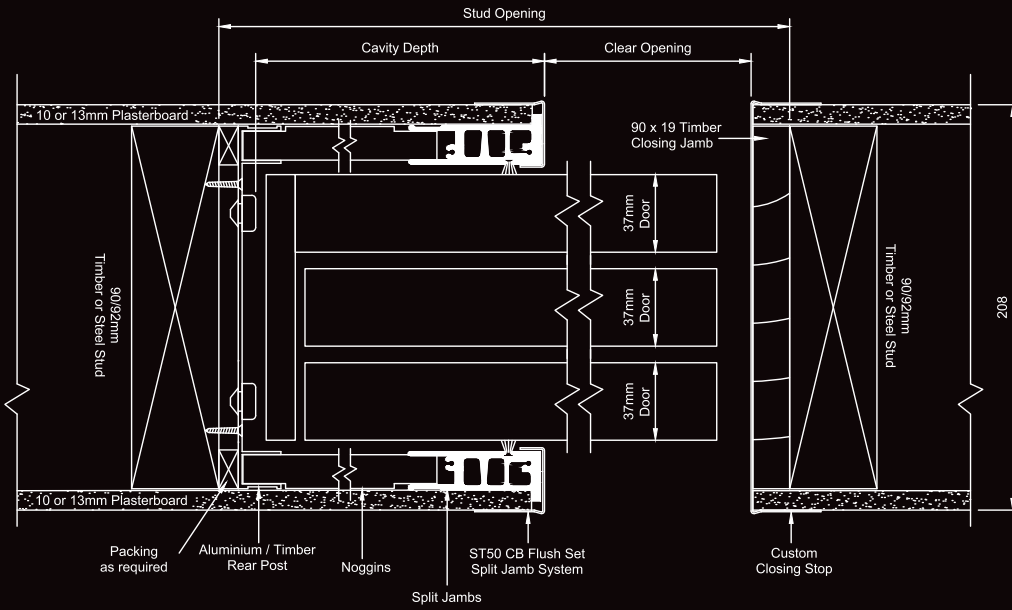
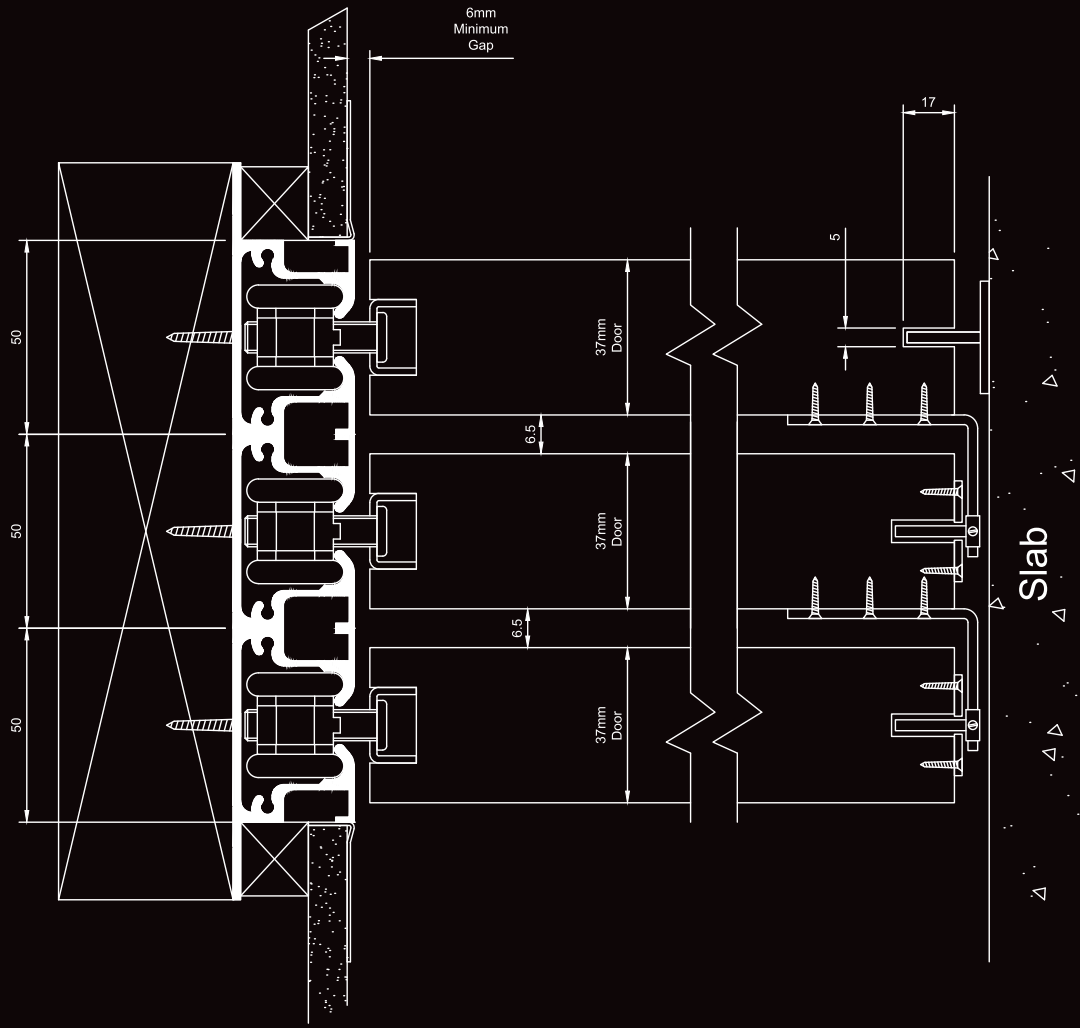

NOTE: Double and Triple Overtaking Doors Options Available

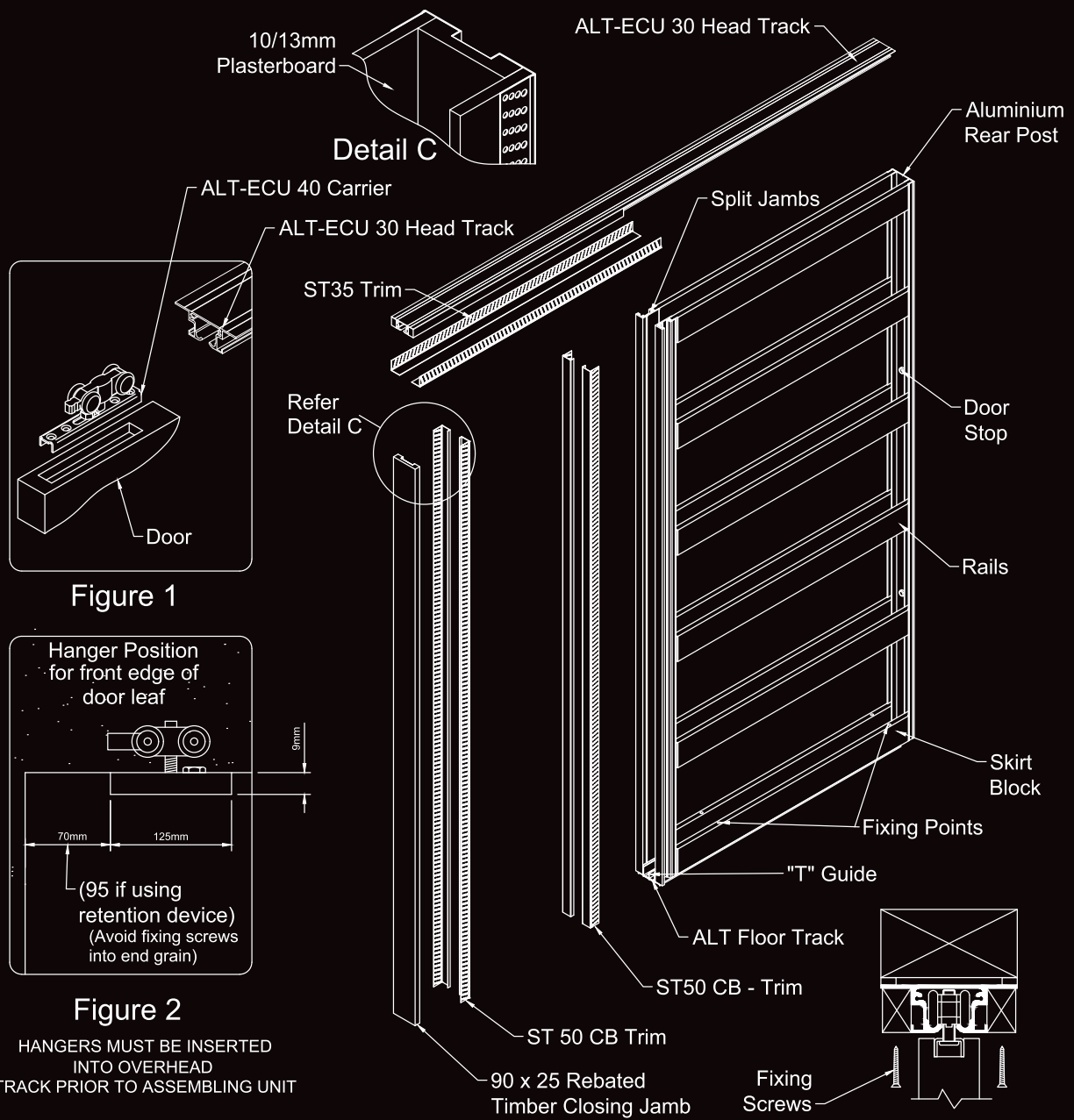

Figure 1

Figure 2

HANGERS MUST BE INSERTED INTO OVERHEAD TRACK PRIOR TO ASSEMBLING UNIT

ASSEMBLY / INSTALLATION INSTRUCTIONS

1. Check floor for level and cut Closing Jamb to size.
2. Attach ALT-ECU 30 Overhead Track to Cavity Frame and slide ALT-ECU 40 Rollers into Track.
3. Fix Closing Jamb (optional) to ALT-ECU 30 Overhead Track. Fit into place, ensuring it is plumb and square. Pack if necessary and secure to stud work.
4. Fit ALT-ECU 40 Carriage Base Plate to door 80mm from one end (Ref Fig. 1 & 2)
5. Install door into position and check operation before cladding.
6. Clad wall, ensuring fixings do not penetrate through rails.
7. Fit 90 x 25 Rebated Timber Closing Jamb to end of track. Fix ST50CB Trims over Split Jamb and Closing Jamb. Screw into position with bugle head screws.
8. Fit ST35 Trim to ALT-ECU 30 Overhead Track
9. ALWAYS fix bottom track through skirt blocks, Fixing through centre of track is acceptable if using countersunk head screws that do not protrude more than 4mm above the aluminium track to ensure no obstruction to door. (see Detail B)

Fix Head Track Through Flange Blocks ONLY

Detail A

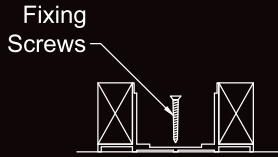

Fix Bottom Track Through Centre

Detail B



ALT-ECU-AI-001-V01

Never drill, nail, or screw through the centre of the track as this will cause the contaminated by aluminium filings and swarf. This will affect the smooth running of the carriages.
Always fix the top track to the stud above from the outside flanges. (see Detail A)



TM
ALTRON
CORPORATION



PO Box 6192, Baulkham Hills BC NSW 2153

P 1300 367 480 | F 1300 766 197 | sales@altro.net.au | www.altro.net.au