

Aluminium edging for perfect design ideas in the garden

Get the Edge

**LINK
EDGE**

- 1 Shape.
- 2 Link.
- 3 Spike.

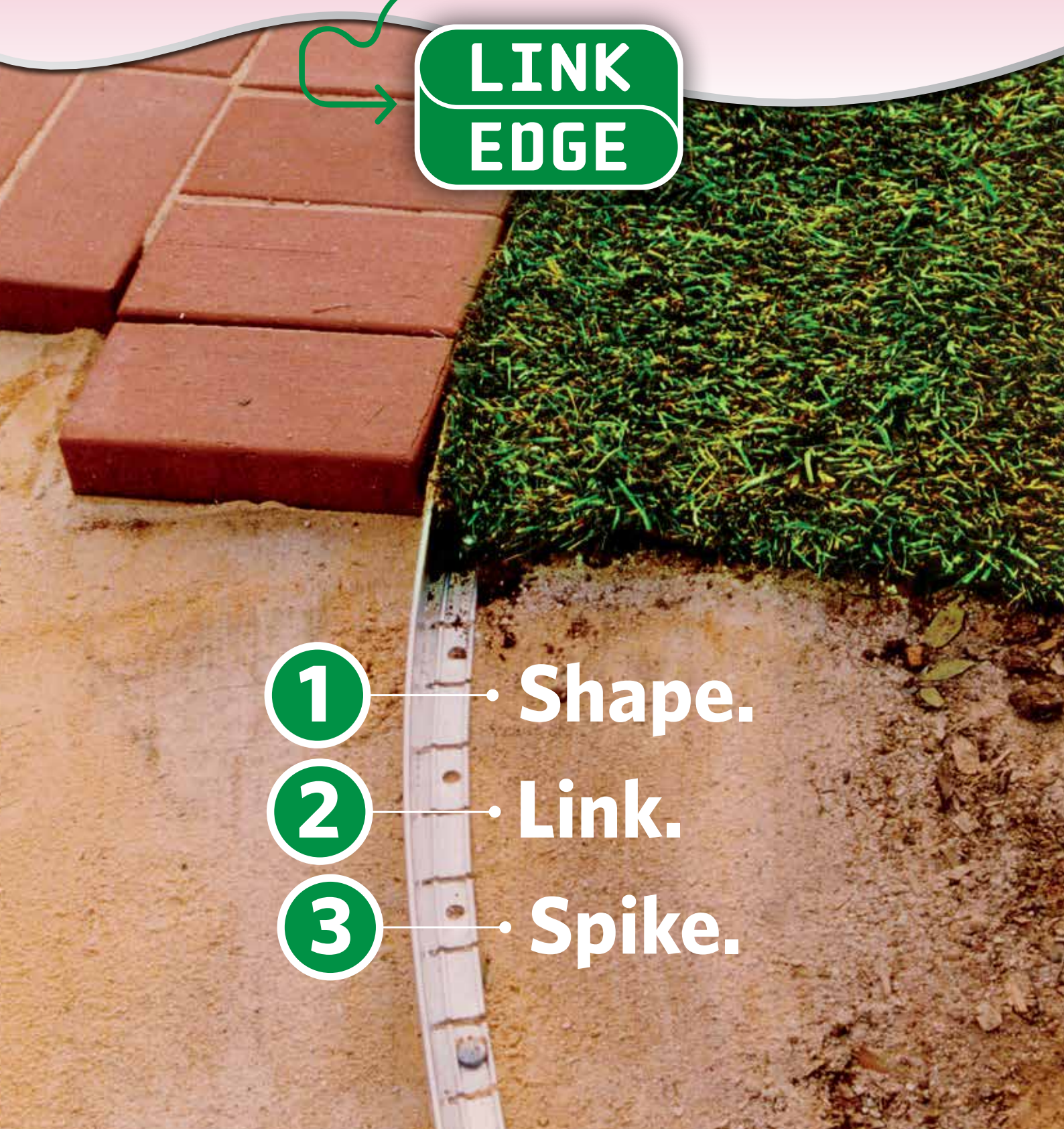

For gardening perfectionists who love design freedom

Aluminium is the perfect material for edging, to unlock incredible new designs and of course to create edging perfection.

While cement cracks, wood rots, plastic fades and steel rusts, aluminium provides durability for years to come.



Product Range

ORIGINAL RANGE

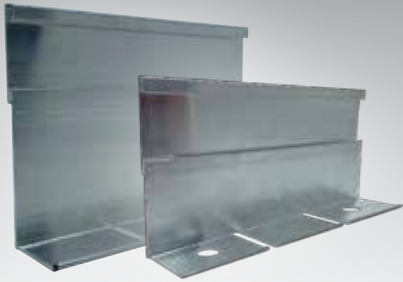

Cost effective, long term border management.

Lengths	Height
2m	40mm
3m	50mm
	60mm
	75mm
	100mm

HEAVY DUTY RANGE



For use in areas of higher-traffic, heavier compaction, harder surfaces and commercial applications.

Lengths	Height
3m	50mm
	75mm
	100mm

CIRCLE & SQUARE RANGE AVAILABLE

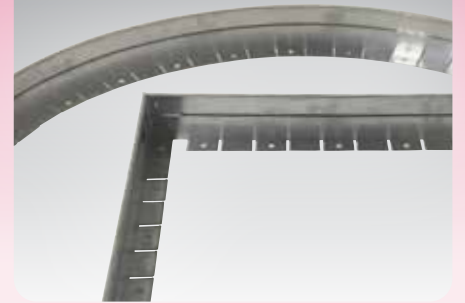

See website for more details

**AVAILABLE
IN A RANGE OF
POWDER COATED
COLOURS**

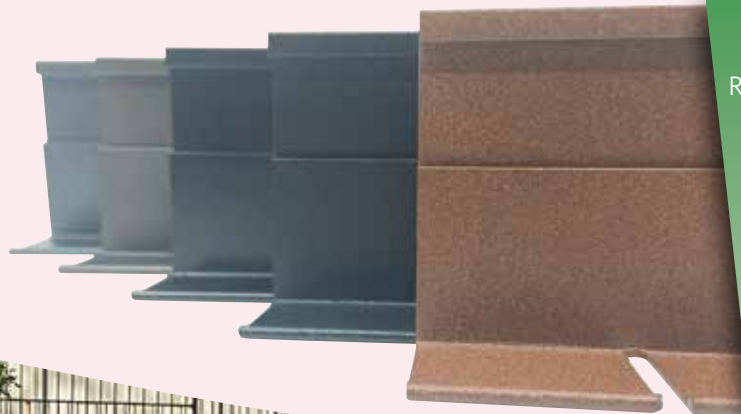

REDUCE

DURABLE AND LONG-LASTING
WITH LOWER POLLUTION
POTENTIAL

RE-USE

RE-USE LINK EDGE IN FUTURE
LANDSCAPING PROJECTS

RECYCLE

ACCEPTED AT RECYCLING
CENTRES IF NO LONGER
REQUIRED



Accessories

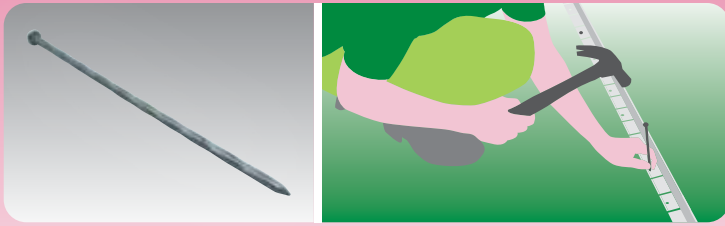

EDGE SPIKES

The spikes are used to securely fix the Link Edge into the ground/surface/base, by hammering through the holes located on the bottom base of the Link Edge.

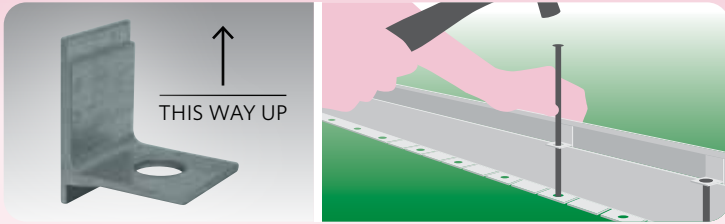

SPIKE GUIDES

When using 75mm or 100mm Link Edge the spike guide slides into the fishplate connector slot, and allows for the spike to go through the guide and then the Link Edge to increase upright rigidity. Always install spike guides with the edge spike hole towards the bottom of the spike guide.

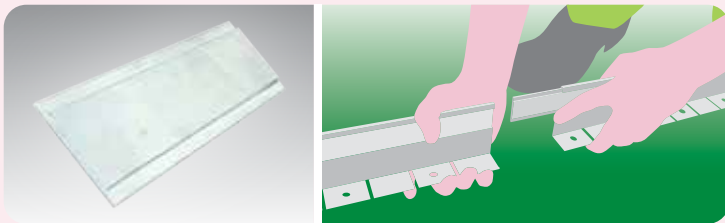

FISHPLATE CONNECTORS

Each length of Link Edge requires one specially designed connecting fishplate that slides into the designed slots and snaps the lengths together providing a smooth uninterrupted edge.

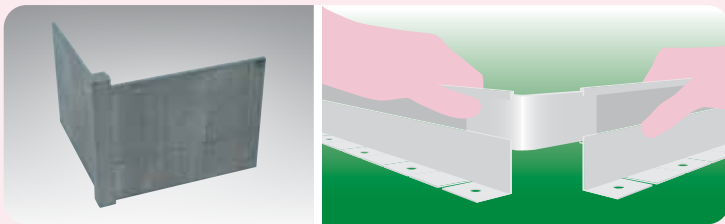

CORNER FISHPLATE CONNECTOR

The corner fishplate connector allows two lengths of Link Edge to be joined at right angles and giving extra stability at a potentially weakened point of the edge.



Step-by-Step Instructions

1

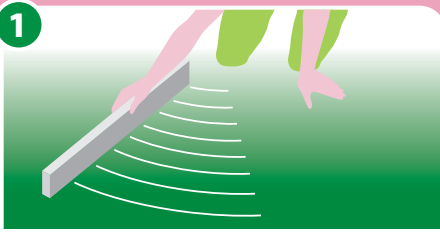

Clear the area, compact and level the base.

2

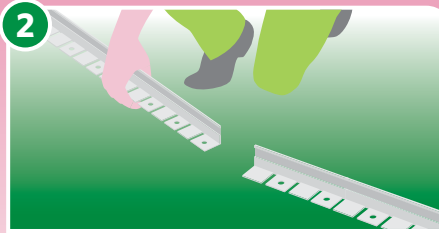

Lay the Link Edge down in the approximate area you require it to be.

3

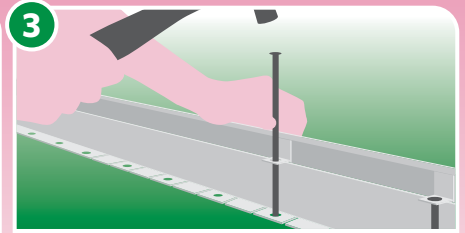

If using 75mm, 100mm or higher Link Edge, use spike guides to provide extra upright rigidity. Ensure edge spike hole is towards the bottom of the spike guide.

4

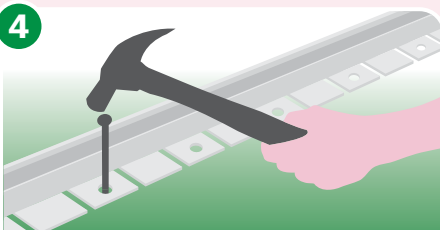

Half hammer spikes into pre-punched holes (approximately 1-2 spikes per lineal metre) starting from the first hole in the end of the Link Edge.

5



Half hammer subsequent spikes in pivotal areas along the length (especially at points where a bend or curve is required).

6



Connect any further 3m lengths together by using the fishplate connectors. Slide the fishplate connector into the designated section at the end of the matching length.

7

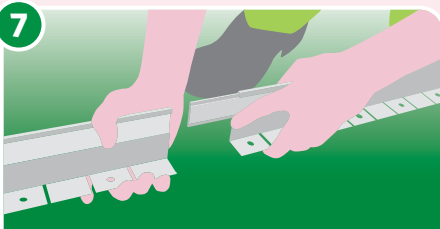

Snap it together with the second Link Edge length enabling for an uninterrupted clear edge.

8

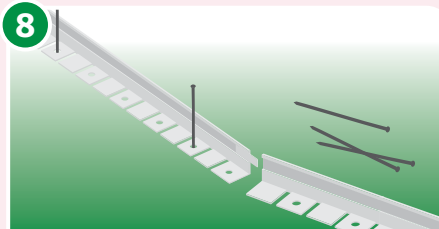

Check that the position of the Link Edge is visually correct. If it is not, remove the spikes and reposition it

9



Once satisfied with the positioning of the Link Edge, hammer the spikes firmly into the ground.

10

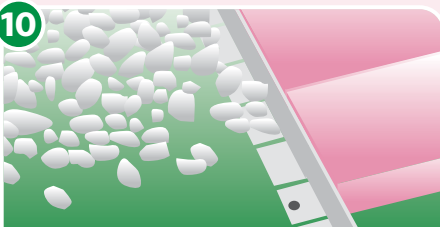

Fill each side of the Link Edge with the desired surface.

11

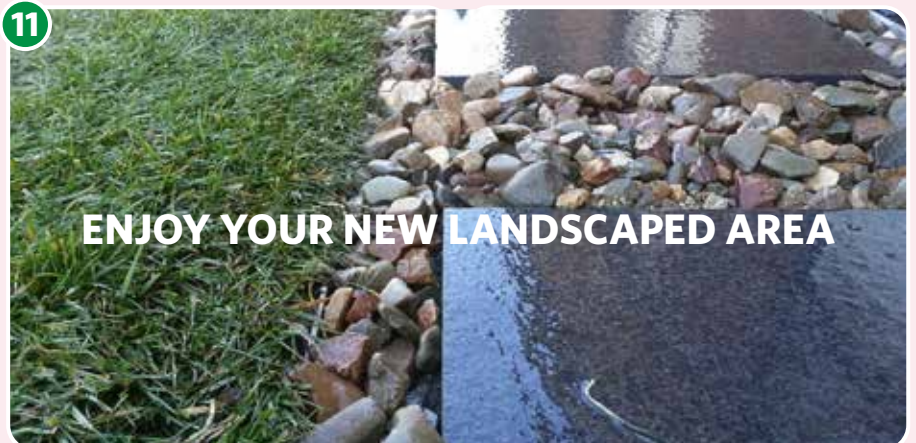

ENJOY YOUR NEW LANDSCAPED AREA

Gardening perfection is as easy as

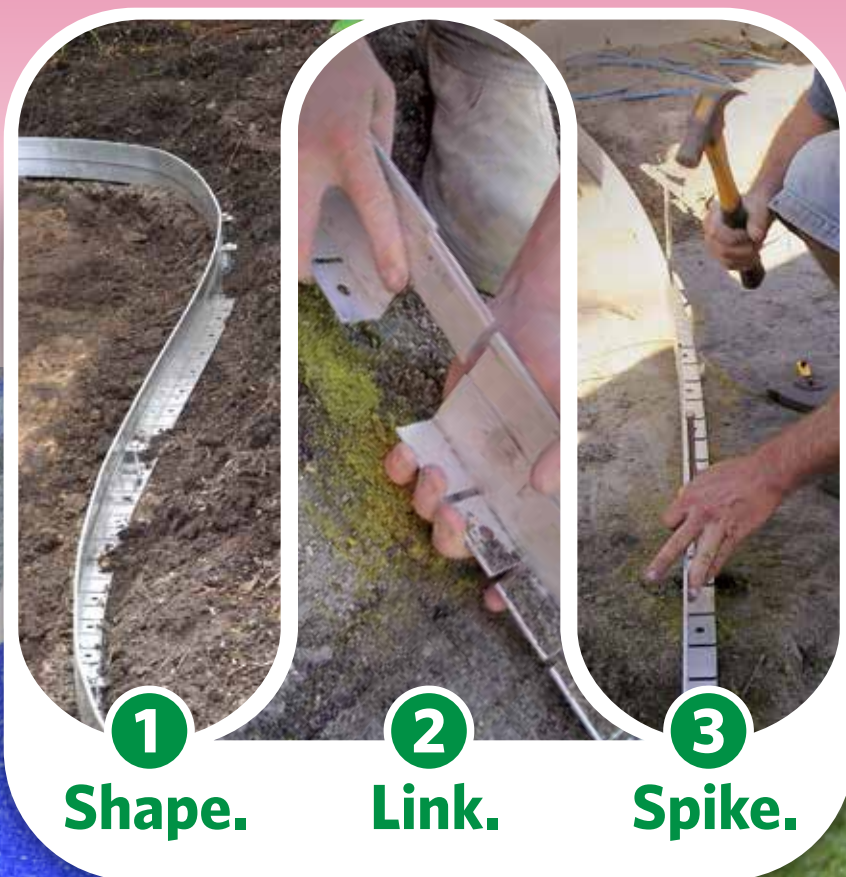

Bring your perfect design to life now

AS USED ON:



FIND YOUR NEAREST LINK EDGE RESELLER

32-34 Cormack Road, Wingfield, South Australia 5013

Telephone: +61 (08) 8347 4447

Facsimile: +61 (08) 8312 0223

linkedge.com.au

OriginalLinkEdge

OriginalLinkEdge

@originallinkedge

Disclaimer: Edging, accessories and kits in the Link Edge range ("Products") are provided by Dagenham Pty Ltd "as is". You must form your own view as to the suitability of the product for your use, and accept all responsibility in relation to that use. By using the Products, you acknowledge and agree that you have done so. Any statements by Link Edge concerning the Products are intended solely to be a guide to the features and use of the Products. The Products must be used correctly to perform the functions indicated. Link Edge will not be liability for any injury, loss or damage (including without limitation any direct, indirect or consequential loss) in connection with the Products. Link Edge reserves the right to modify or discontinue any Products or prices or any literature referring to any Products at any time without notice. Link Edge excludes all conditions, warranties and terms implied by statute or otherwise, other than any condition, warranty or term the exclusion of which would contravene the Competition and Consumer Act 2010 or cause any part of this disclaimer to be void ("Non-excludable Condition"). Link Edge's liability for breach of any Non-excludable Condition is limited, at Link Edge's option, to re-supplying, replacing or repairing the specific Products affected."