



PALINKA-2CWP & PALINKA-3CWP USB-C Pro Wallplate solutions utilising CAB-USBCM-USBCF-L150A & CAB-USBC-T200C / T300C

SKU: LWRA-USBC2C-WPMECH-K and LWRA-USBC3C-WPMECH-K

Lightware's [CAB-USBCM-USBCF-L150A](#) USB-C Port Saver Cable provided us with the perfect basis to create Lightware's very first Pro USB-C Wallplate with full featured functionality & true Blind Mating between Host & connected equipment.



We are pairing the USB-C Female side with Clipsal's *Iconic* range of quality 1-Gang plates via a custom engineered mount for a full-featured USB-C in wall solution. To ensure guaranteed performance throughout, our engineered USB-C Wallplate is offered with 3.5m or 4.5m total range, made up from the 1.5m Port saver cable, combined with either a 2m (T200C) or 3m (T300C) USB-C to C cable as the Host connection into the USB-C (F) port.

- These two combinations have been tested to ensure proper signal conditioning and reliable performance, maintaining USB 2.0 and USB3.2 data, 4K60 4:4:4 Video and 60W/3A Charging for connected equipment
- Unique true blind mating on any side of connected USB-C ports
- Secure & Serviceable mounting of USB-C mech into Clipsal insert
- Bend radius that allows ease of installation in wall cavities

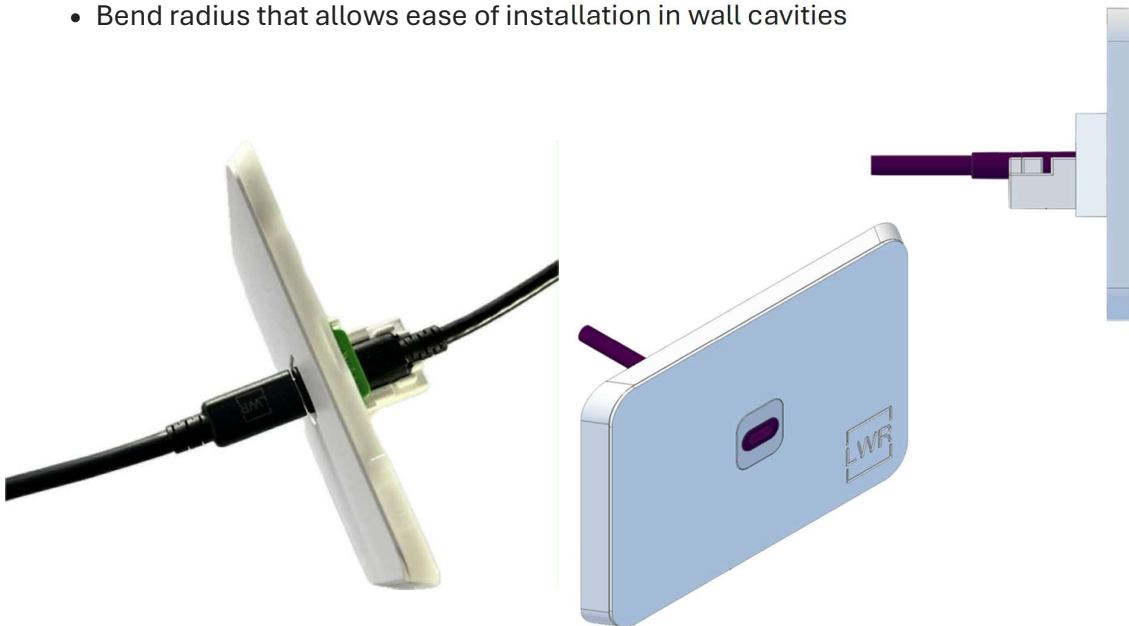

Please use Lightware Certified cables as recommended, because Lightware cannot guarantee blind mating or stable operation with any other USB-C host cables, or the use of USB-C host cables beyond 3m length for this application.

End-to-end system performance is guaranteed with Lightware Certified cables.